

Dowel Pin

Material: Hardened Alloy Steel

Class Grade: High Tensile

Finish: Plain Black Uncoated

Corrosion Protection Level: Poor

Standard: DIN 6325

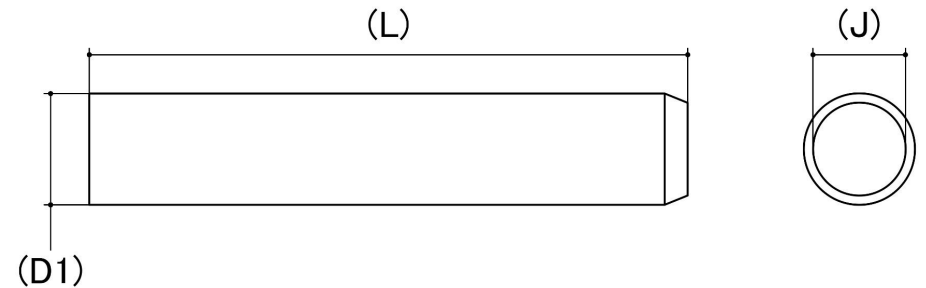

CAD drawings shown for graphic representation only.*

Size	Dowel Pin Diameter (D) (mm)		Point Diameter (J) (mm)		Crown Height (mm)	Length Round End Chamfer (mm)	sku (qfind)
	Min	Max	Min	Max	Nom	Nom	
M2	2.00	2.01	1.60	1.90	0.60	0.18	37DP2P
M2.5	2.50	2.51	2.10	2.40	0.70	0.25	37DP25P
M3	3.00	3.01	2.60	2.90	0.80	0.30	37DP3P
M4	4.00	4.01	3.60	3.90	0.90	0.40	37DP4P
M5	5.00	5.01	4.60	4.90	1.00	0.50	37DP5P
M6	6.00	6.01	5.40	5.80	1.10	0.60	37DP6P
M8	8.00	8.01	7.40	7.80	1.30	0.80	37DP8P
M10	10.00	10.01	9.40	9.80	1.40	1.00	37DP10P
M12	12.00	12.01	11.40	11.80	1.60	1.30	37DP12P
M16	16.00	16.01	15.30	15.80	1.80	1.70	37DP16P

Disclaimer:

Dimensional data and technical information was obtained from publically available sources and not acquired through standard agencies. It has been completed and compiled for reference purposes only; where discrepancies are found they are subject to change without notice. Bolt & Nut Australia makes no warranties or representations regarding the accuracy and validity of the compiled information and data. Contact the relevant standard authorities for accurate and detailed information.

* CAD drawings may not reflect diameter, thread length or overall length.

© Bolt & Nut Australia Pty Ltd. All rights reserved.

Version: 18 Mar 2024